

MILESTONES IN MANUFACTURING

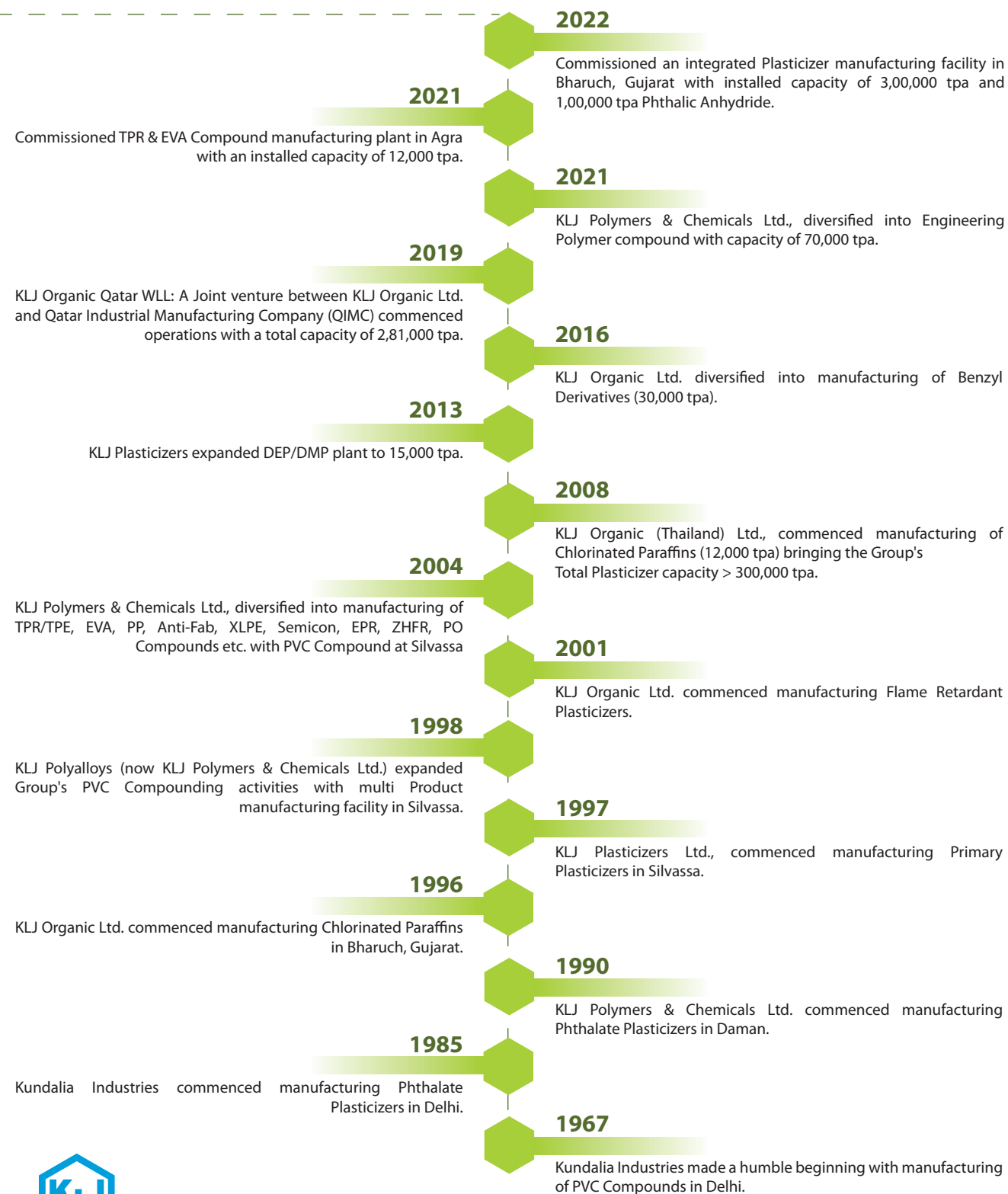

KLJ GROUP
SINCE 1967

Corporate Office:

KLJ House, 8A, Shivaji Marg,
Najafgarh Road,
New Delhi - 110 015, India
Tel.: +91 11 41427427/28/29
Email: delhi@kljindia.com

Domestic Offices:

Mumbai : +91 22 61830000 mumbai@kljindia.com
Chennai : +91 44 42383622 chennai@kljindia.com
Kolkata : +91 33 22823851 kolkata@kljindia.com
Ahmedabad : +91 9289590026 ahmedabad@kljindia.com

International Offices:

Dubai | **Singapore** | **Doha**

www.kljindia.com

Silvassa | Bharuch | Agra | Kutch | Rayong (Thailand) | Mesaieed (Qatar)



KLJ GROUP
SINCE 1967

TRUST BUILT ON PERFORMANCE

... sustaining life with natural footprints

#23-113/KLJGROUP/JULY/2023

Plasticizers | Polymer Compounds | Benzyl Derivatives | Chlor Alkali | Petrochemical Distribution | Real Estate Development

CORPORATE LEADERSHIP



Kamal Jain
Director

K. L. Jain
Chairman

Hemant Jain
Director

Pushp Jain
Director

I believe that nothing is more powerful and prevailing than reinventing oneself against a world of changes; a world of dynamic competitive environment, global growth, raw material changes and sustainability. Team KLJ is responsive to the changing dynamics of industry and market by integrating breakthrough innovation, new technologies and overall operational excellence.

We operate by keeping in mind the goal of maintaining a uniqueness of our own in whatever stream of business we undertake.

Looking at our performance over the last 50 years, I'm pleased to say that we have recorded a well-balanced growth across our portfolio of businesses.

Today, KLJ is leading from the front with an empowered sense of ownership and supreme confidence in what the future unfolds for us.

Kanhaiya Lal Jain

Chairman, KLJ Group

KLJ GROUP

Founded in 1967, KLJ is not only the **Largest Manufacturer and the Market Leader in Plasticizers & Polymer Compounds in South Asia**, but also an outright leader in the Secondary Plasticizer - **Chlorinated Paraffin** segment as the **Largest Manufacturer across the Globe**. Their Ultra-Modern Manufacturing facilities in Silvassa, Bharuch, Agra & Kutch in India, Rayong in Thailand and Mesaieed in Qatar are equipped with State-of-the-Art Technology and Equipment, producing a wide range of products to meet their Customers' Requirements.



Group has a combined **Manufacturing Capacity of 1.4 Million tpa**.

In 2022, Group has started an integrated manufacturing plant with installed capacity of 300,000 tpa of Plasticizers and 100,000 tpa of Phthalic Anhydride in Bharuch, India.

In 2019, a State-of-the-Art **Chlor Alkali** complex in Qatar was established with a total investment in excess of USD 125 Million. It is a joint venture project with Qatar Industrial Manufacturing Co. (QIMC).

In 2016, Group had diversified into manufacturing of **Benzyl Derivatives** in Bharuch, India.

The Group has also made strong in-roads into the **Distribution of Petrochemicals** and is proud to be in **No. 1 Chemical Distribution Company in India**.

Identifying infrastructure as a significant factor in the development of the national economy, the Group has also expanded into **Real Estate Development**.

Total Solution In Plasticizers & Polymer Compounds

Turnover & Workforce -
Turnover exceeding ₹ 10,900 Crores (USD 1.4 Billion) and 2200+ strong workforce

Certifications -
REACH,
ISO 9001:2015,
ISO 14001:2015,
ISO 13485:2016,
ISO 17025:2017,
ISO 45001:2018,
TFS, ROHS,
IATF 16949:2016,
FDA, HALAL,
KOSHER

Spreading Happiness (CSR) -
The Group is committed to social objectives such as improving lives and spreading happiness

TOTAL SOLUTION IN PLASTICIZERS



KLJ Plasticizers Limited, Silvassa

PLASTICIZERS

Largest Manufacturer & Market Leader of Plasticizers in South Asia with an Installed Capacity of over 665,000 tpa

Manufacturing Capacities ensure the advantage of Widest Range, Consistent Quality & Assured Supplies to the Customers

Offering Largest Range of Plasticizers Globally, to meet present & evolving needs of the Customers

Dedicated lines for Non-Phthalate, REACH compliant & Food Grade Plasticizers

EXPANSION & BACKWARD INTEGRATION

Greenfield backward integrated facility at Bharuch instrumental in expanding the manufacturing capacity of Plasticizers to 665,000 tpa and 100,000 tpa of Phthalic/Maleic Anhydride

EXTENSIVE R&D

Centre supported with in-house compounding & application laboratory to develop new products and applications

IN HOUSE PACKAGING PLANT

HDPE Drums manufacturing facilities at our India, Thailand and Qatar plants

MULTI-LOCATIONAL MANUFACTURING FACILITY

Primary Plasticizers at Silvassa & Bharuch (India)
Chlorinated Paraffin at Bharuch (India), Rayong (Thailand) & Mesaieed (Qatar)

COMPLIANCES

Consistent quality and reliable performance for standard and special applications, along with the dedicated lines for Non-Phthalate, REACH compliant & Food Grade Plasticizers

TOTAL SOLUTION IN PLASTICIZERS



PRODUCT RANGE

KANATOL Phthalate Plasticizers		
Kanatul 1212 [DDDP]	Kanatul 1210 [DUDP]	Kanatul 1000L [DDP(L)]
Kanatul 1001 [DiDP]	Kanatul 1010 [DPHP]	Kanatul 900 [DiNP]*
Kanatul 800 [DOP]	Kanatul 800 FG [DOP-FG]*	Kanatul 1056**
Kanatul 8461	Kanatul 7720**	Kanatul 470 [BBP]
Kanatul 400 (M) [DBP-M]**	Kanatul 400 (N) [DnBP]	Kanatul 400 (I) [DiBP]
Kanatul 200 [DEP]	Kanatul 100 [DMP]	

KANATOL Speciality Plasticizers		
Kanatul 10A [DiDA]	Kanatul 9A [DiNA]*	Kanatul 8A [DOA]*
Kanatul 3A [DiPA]	Kanatul 1A [DEA]	Kanatul 1A [DMA]
Kanatul 3001 [TiDTM]	Kanatul 3000 [TPHTM]	Kanatul TM 8-10L [TODTM(L)]
Kanatul TM 8-10 [TODTM]	Kanatul 3900 [TiNTM]	Kanatul 3800 [TOTM]
Kanatul HT9**	Kanatul 3400AC [ATBC]*	Kanatul 3400C [TBC]
Kanatul 3200AC [ATEC]	Kanatul 3200C [TEC][100% Bio]	Kanatul 3430E**
Kanatul 80S [OS]	Kanatul 40S [nBS]	Kanatul 8S [DOS]
Kanatul 4S [DBS]	Kanatul 1S [DMS]	Kanatul DPGB50 [DPGDB-50]
Kanatul DGB [DEGDB]	Kanatul 9449	Kanatul 9090 [DiNTP]
Kanatul 8080 (FG)* [DOTP]	Kanatul 4040 [DBTP]	Kanatul 1120**
Kanatul 9061**	Kanatul 9428**	Kanatul B-40 [Bio]

KANATOL Maleate Plasticizers		
Kanatul 9M [DiNM]	Kanatul 8M [DOM]	Kanatul 4M [DBM]
Kanatul 2M [DEM]	Kanatul 1M [DMM]	

KANATOL Polymeric Plasticizers		
Kanatul PA 33	Kanatul PA 90	Kanatul PA 110

KANAMOLL Epoxidized Soybean Oil	
Kanamoll 620 [Bio]	Kanamoll 650 [Bio]

KANACHLOR Chlorinated Paraffin (CP)	
An Extensive Range (incl. vLCCP & LCCP) of Chlorinated Paraffin grades are manufactured with varying paraffin carbon chains, chlorine contents & stabilizers to suit the specific needs of the customers.	
* Approved for Food Contact Application	- REACH Registered Products Available
** Proprietary Plasticizers	- FDA Certified Plant

APPLICATIONS

Medical Devices	Rubber Belt	Catalyst
Paint	Wires & Cables	Leather Cloth
Automobile Parts	Flexible PVC Film	Adhesive
Non Toxic Food Packaging	Flexible Pipes & Tubing	Chemical Intermediates
Lubricants	Vinyl Flooring	Footwear
Metal Working Fluids	Flavour & Fragrance	Perfumery

TOTAL SOLUTION IN POLYMER COMPOUNDS

POLYMER COMPOUNDS

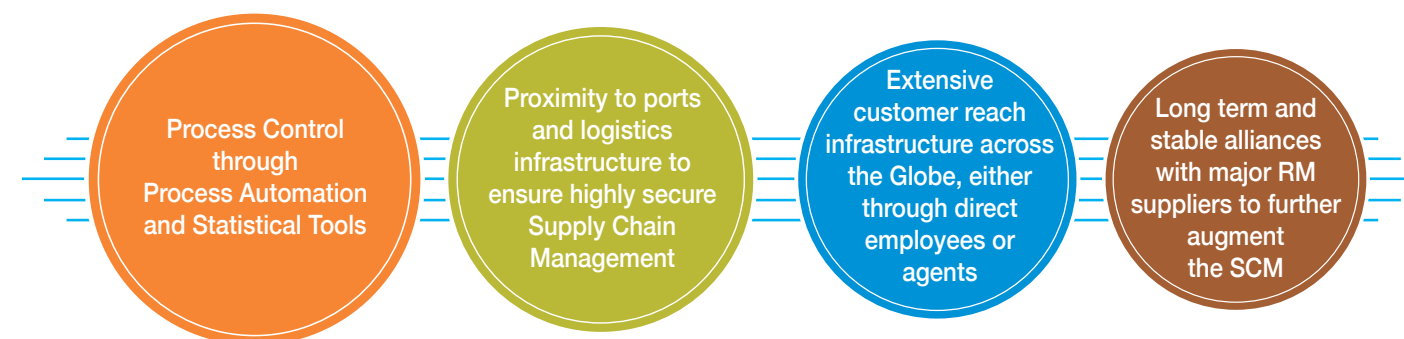
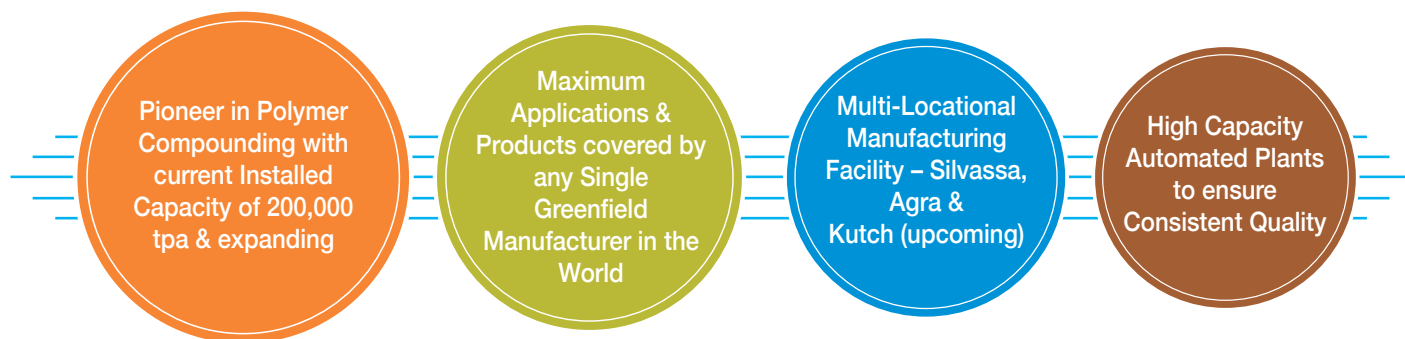

EXPANSION IN SILVASSA

For production of PP & EP with a capacity of 70,000 tpa

NEW FACILITY IN AGRA

For production of TPR & EVA with a capacity of 12,000 tpa

EXTENSIVE R&D

Customization backed by extensive R&D, Testing & Application facilities

BACKWARD INTEGRATED PLASTICIZER

Manufacturing within the Group

COMPLIANCES

REACH, RoHS, SATRA, FDA, ISO/IEC 17025:2017 (Quality Lab Management Assurance Certificate), DSIR, ISO 9001: 2015, ISO 14001:2015; ISO 13485:2016 (Medical Devices Quality Management System); IATF 16949:2016; ISO 10993-18 (For PVS Medical Compounds for Biocompatibility)



KLJ Polymers & Chemicals Limited, Silvassa



TOTAL SOLUTION IN POLYMER COMPOUNDS



PRODUCT RANGE

- PLENE** | **Polypropylene Compound***
Automotive, Appliance, Electronic & Electrical, etc.
- EP** | **Engineering Polymer Compound***
ABS, ASA, SAN, PA6, PA66, PBT, PET, PPO, PPE, PC, POM & varieties of blends and alloys for Automotive, Appliance, Electronic & Electrical, etc.
- VINYL** | **PVC Compound**
Footwear, Wire & Cable, Medical, Automotive, Sports, Profile, Rigid, etc. Dedicated line for Phthalate-Free grades & Clean Room for Medical & Food grade
- XL** | **Sioplas PE Insulation Compound**
Silane Grafted XLPE for MV (35 KV), LV, Aerial Bunched, FR, Forced/Ambient curable
- PX** | **Peroxide PE Insulation Compound**
Peroxide XLPE for CCV Lines (up to 72 KV)
- SEM** | **Semi Conductive Cable Compound**
Black Semi Conductive Compounds for Shielding of Conductor & Insulation. Bonded & Strippable
- EPR/XLPO** | **EPR/XLPO Compound**
Cross Linkable EPR Cable Compound (up to 35 KV)
- ZHFR** | **Zero Halogen Flame Retardant Compound**
Sheathing and Insulation for Wires & Cables for a wide range of applications including cross-linkable grades
- PO** | **Polyolefin Compound**
HDPE/MDPE/LDPE/LLDPE Compounds for Insulation & Sheathing
- 3LP** | **HDPE Compound**
Polyolefin based Compound for 3 layered Steel Pipe
- FLEX** | **TPR & TPE Compound**
Footwear, Medical, Profile, Pen Grip, Tooth Brush Grip, Pipe Gasket, Polymer Modifier, etc.
- VA** | **EVA Compound**
Footwear

APPLICATIONS

- Medical Devices
- Automotive
- Appliances
- Defence
- Railways
- Electrical & Electronic
- Wires & Cables
- Footwear
- Flexible Profile
- Hygiene
- Irrigation
- Stationery
- Pipe Coating
- Engineering
- Flooring/Sheeting
- Heating Pipe
- Packaging
- Sports
- Rigid Profile
- Gasket
- Flexible & Rigid Moulding
- Mining
- Hose Pipe

MASTERBATCHES

- VMB** | PVC Masterbatch
 - PMB** | PE Masterbatch
 - UMB** | Universal Masterbatch
- FUNCTIONAL** | Like UV, AT, AR, FR etc. in various polymer bases

REACH/RoHS/Phthalate Free grades also available

* IATF 16949:2016 Certified



SOLUTION IN BENZ PRODUCTS

World-Class Plant with an Installed Capacity of 30,000 tpa

Strategically located very close to a Chlor Alkali Plant ensuring consistent supply of Chlorine through pipeline

One of the largest importers of Toluene, having storage facility at all major Indian Ports

Continuous process plant with State-of-the-Art technology in Bharuch

EXPANSION

Manufacturing capacity to be expanded to 50,000 tpa by 2023

REACH COMPLIANCE

The plant is equipped with dedicated lines to produce REACH compliant Benz Products

PRODUCT RANGE

- | | | |
|------------------------------|---------------------------------------|------------------------------|
| BOH Benzyl Alcohol | BCHO Benzaldehyde | BCL Benzyl Chloride |
| DBE Di Benzyl Ether | BACE Benzyl Acetate | SB Sodium Benzoate |
| BB Benzyl Benzoate | - REACH registered products available | |



APPLICATIONS

- | | | |
|---------------------------|-----------------------|-------------------|
| Epoxy Hardener | Paint | Cinnamaldehyde |
| Construction Chemicals | Cosmetics | Rose Crystal |
| Meta Phenoxy Benzaldehyde | Perfumery | Flavoring |
| Food Additives | Benzalkonium Chloride | Drug Intermediate |
| Alpha Amyl Cinnamaldehyde | Malachite Green | Ink |
| Dyes | Pharmaceuticals | Preservative |

SOLUTION IN CHLOR ALKALI

An integrated Chlor Alkali Complex at Mesaieed Industrial city in Qatar

Installed Capacity
 CP – 51,000 tpa
 Caustic Prills – 1,12,000 tpa
 HCL – 51,000 tpa
 CaCl₂ – 60,000 tpa
 NaClO – 6,600 tpa

Joint Venture with Qatar Industrial Mfg. Company (QIMC)

Capital Investment in excess of USD 125 Million

LOCATIONAL ADVANTAGE

Strategic locational advantage for Middle East and North African market

FORWARD INTEGRATED CALCIUM CHLORIDE MANUFACTURING PLANT

A joint venture between KLJ Organic Qatar W.L.L. and Gulf Chlorine to produce Calcium Chloride

PRODUCT RANGE

- | Caustic Soda Prills (99.5%)
- | Chlorinated Paraffin
- | Hydrochloric Acid (32% Liquid)
- | Sodium Hypochlorite (10% Liquid)
- | Calcium Chloride Prills (94% Solid)



KLJ Organic Qatar W.L.L., Qatar

RESEARCH & DEVELOPMENT

INVESTING IN TECHNOLOGY AND EXPERTISE FOR NEW PRODUCTS & PROCESSES

State-Of-The-Art Equipment

State-of-the-Art equipment for end applications to study the product behaviour for different end uses like extrusion, injection moulding, film/sheet making, etc

Latest Machinery

Rich library and latest application machinery to test products for specific applications

Our 55,000 sqft. State-of-the-Art R&D Facility enables KLJ Group to be at the forefront of the latest Development & Product Innovation

Clear focus on R&D keeps the Group ahead of the competition and provides Customized Solutions to their Customers

APPLICATION DEVELOPMENT

- * Pilot Plants of various capacities/configuration
- * FTIR
- * DSC/TGA
- * UV
- * Weatherometer
- * GCs
- * Autoclaves
- * Rheometer
- * Extreme Conditions UTM

APPLICATION PLANTS

- * Wire
- * Sole
- * Foam Sole
- * Film
- * Tubing
- * Injection Moulding
- * Flammability
- * High Voltage Test
- * Track Resistance



PETROCHEMICAL DISTRIBUTION

BUILDING A STRONGER ECONOMY

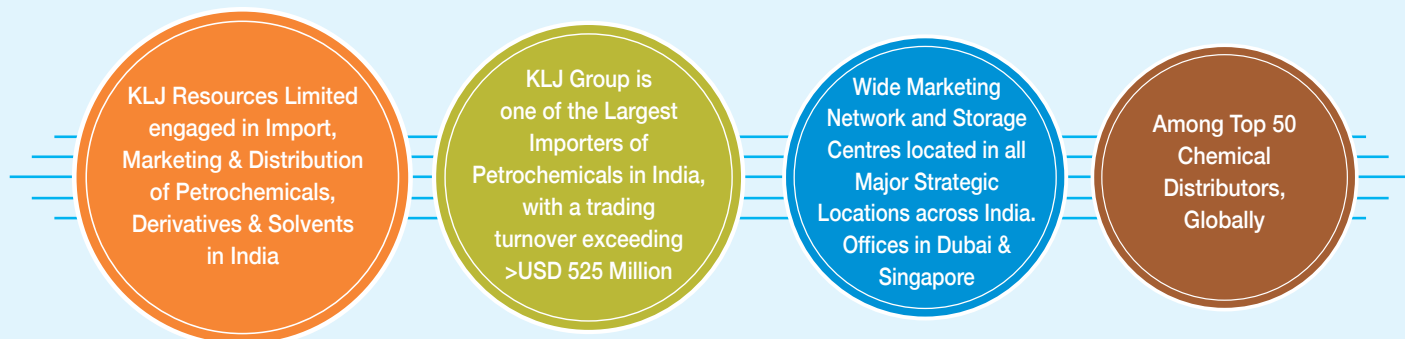

PRODUCT RANGE

Covers a range of Paraffins, Linear Alkyl Benzene, Glycol Ethers, Oxo Alcohols, Aromatics, Ketones, Monomers, Esters, Amines, Polyols, Isocyanates and Silicones, to name a few

PAN-INDIA PRESENCE

With PAN-India presence, KLJ Group leverages on its modern R&D facility to provide comprehensive and complete solutions

COMPLETE CUSTOMER SATISFACTION

With a Robust Marketing Network, Storage Tanks (with sales of over 500,000 MT), Drumming and Distribution facilities; KLJ ensures complete Customer Satisfaction across the value chain



Anything not made from Nature, is made from Petrochemicals

REAL ESTATE DEVELOPMENT



KLJ GREENS
Sector-77, Faridabad



PLATINUM HEIGHTS
Sector-77, Faridabad



PLATINUM FLOORS
Sector-77, Faridabad



PLATINUM PLUS
Sector-77, Faridabad



PARK CENTRA
Gurugram



NOIDA ONE
Sector-62, Noida



KLJ SQUARE
Sector-83, Gurugram

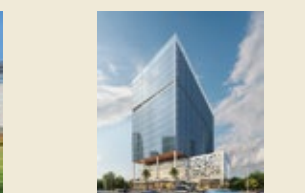

NOIDA 126 IT PARK
Sector-126, Noida

REAL ESTATE

Since its incorporation, KLJ Developers Private Limited has built an unparalleled legacy as a developer with innovative projects in National Capital Region. With the company's transparent approach, an idea of the highest level of customer satisfaction and customer need with the support of a skilled team of Engineers and Architects KLJ has delivered various IT/ ITES, Residential, Commercial & Retail Projects.

LANDMARKS THAT MARK THE DIFFERENCE...

RESIDENTIAL

- KLJ GREENS
- KLJ HEIGHTS
- NAKSHATRA
- NIRVANA FLOORS
- PLATINUM FLOORS
- PLATINUM HEIGHTS
- PLATINUM PLUS
- VEDANTA

COMMERCIAL

- KLJ SQUARE
- KLJ TOWER NORTH
- SHOP IN PARK NORTH

IT/ITES

- NOIDA ONE
- PARK CENTRA
- NOIDA 126 IT PARK
[Upcoming project]



NIRVANA FLOORS
Sector-15, Bahadurgarh



KLJ HEIGHTS
Sector-15, Bahadurgarh

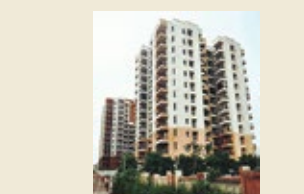

VEDANTA
Sector-15, Bahadurgarh



NAKSHATRA
Sector-15, Bahadurgarh

OPERATIONS

EXTENSIVE MARKETING & DISTRIBUTION
AUGMENTED BY TECHNICAL SUPPORT

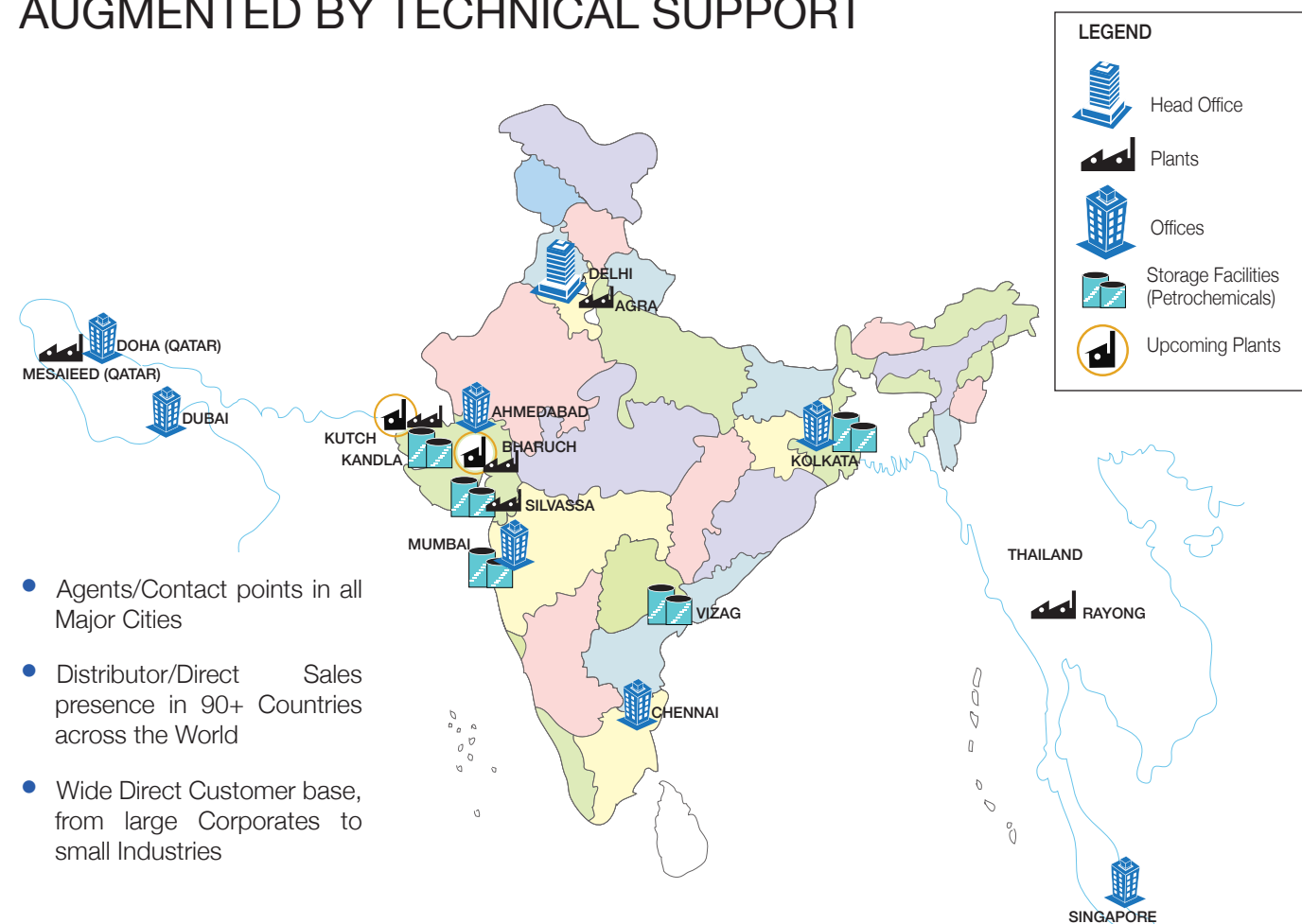

- Agents/Contact points in all Major Cities
- Distributor/Direct Sales presence in 90+ Countries across the World
- Wide Direct Customer base, from large Corporates to small Industries

WORKING TOGETHER ACCOMPLISHING TOGETHER

THE PEOPLE

Our people are our most valuable asset and key to achieving our mission of Quality and Customer Satisfaction. With over 2200+ trained personnel forming a dedicated workforce, we're well equipped to meet the challenges of this industry. Appreciating their invaluable contribution, we ensure training and development programs to equip them with requisite knowledge and expertise.

Coming together is beginning. Keeping together is progress. Working together is success.

MAKING GROWTH INCLUSIVE BY ALIGNING

OUR ASPIRATIONS WITH THE COMMUNITY



“GREEN AND SAFE KLJ” is our corporate motto which comes by integrating social responsibility with company achievements. Believing in the dictum that “Businesses can be successful only when the society around them thrives and prospers”, we undertake initiatives to promote Education, Sports, Human Values, Safety and Healthcare for Society's Welfare.

SAFE SOCIETY

We follow a policy of “Zero Discharge – Zero Accident” to ensure safety for our employees, neighbours and environment.

CSR IN EDUCATION

Quality education is the need of today and builder of tomorrow. We fulfil this objective through our institutions that offer education to children and make them productive citizens of tomorrow.

Sumermal Jain Public School, Delhi (2 branches : 2500+ students) | Girls School in Bikaner, Rajasthan | College in Ganganagar, Rajasthan.

CSR IN HEALTHCARE

KLJ Group has recently partnered in **Jessa Ram Hospital, Delhi, India.**

KLJ Group has further sponsored an operation theatre in **Sewa Rural Hospital, Bharuch, India.**

Conduct regular Health Camps & Blood Donation drives to encourage the spirit of humanity and donations for those in need, for last 11 years

Ethics is knowing the difference between what you have a right to do and what is right to do

